

8th September 2008

Executive Ceilings
PO Box 1342
Canning Bridge, WA 6153

Dear Bill

The two Units at 39 Canning Highway, East Fremantle have reached Practical Completion.

This is just a note of thanks from us at Kensington Design to everyone who contributed to the success of this challenging project. – We sincerely appreciate your effort.

The houses are a reflection of everyone's care, professionalism, timeliness and quality of work in the building process.

These units turned out to be stunning and we are proud of everyone's contribution towards the end result.

Thank you!

Regards

James Thorogood

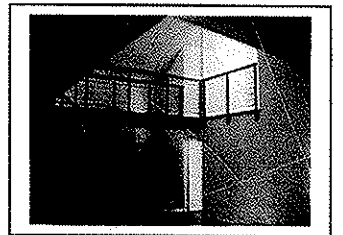
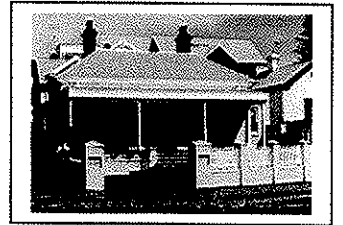

East Fremantle WA 6158
Phone: 9438 3288
Fax: 9438 3299
kd@kensingtondesign.com.au
www.kensingtondesign.com.au

Director: James Thorogood
Director: Sally Pearse
Associate: Hugh Whettters